

Notes:

1. Material: PA66 UL94 V2;
2. Color: Natural;
3. Male (M2) Torques:  $\cong 0.06$  Nm;  
 Male (M2.5) Torques:  $\cong 0.08$  Nm;  
 Male (M3) Torques:  $\cong 0.13$  Nm;  
 Male (M4) Torques:  $\cong 0.3$  Nm;  
 Male (M5) Torques:  $\cong 0.58$  Nm;  
 Male (M6) Torques:  $\cong 0.8$  Nm;
4. RoHS Compliant.

REV	DESCRIPTION	DATE	CHECK
A1	The mark position of "L" changed	2016-4-13	FDL
A2	①2.8 Change to 2.7; ②3.47 Change to 2.7; ③4.2 Change to 3.3; ④Ø7.6 Change to Ø8.4; ⑤1.25 Change to 1.3; ⑥1.47 Change to 1.4; ⑦1.78 Change to 1.8;	2016-7-14	FDL

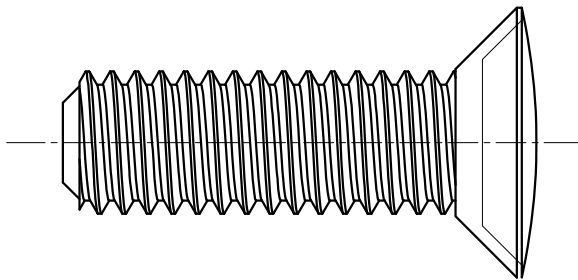
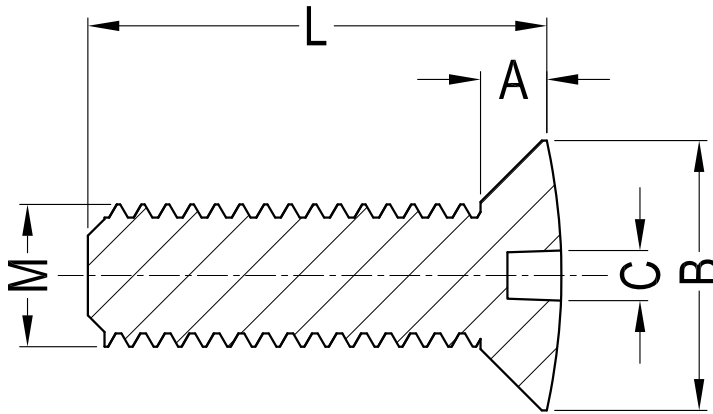

Part No. / Article No.	length																		A	B	C
	5.0	6.0	7.0	8.0	10.0	12.0	15.0	16.0	18.0	20.0	22.0	25.0	30.0	35.0	40.0	42.0	50.0	60.0			
GCSOHS-2010-M2-L	50960	50961		50962	50963	50964		50965	50966	50967									1.2	Ø3.8	0.7
GCSOHS-2010-M2.5-L	50968	50969		50970	50971	50972		50973	50974	50975									1.5	Ø4.7	0.8
GCSOHS-2010-M3-L	50236	50237		50238	50239	50240		50241		50242		50243	50246			50560			1.65	Ø5.5	1.0
GCSOHS-2010-M4-L		50274		50275	50276	50277	50278	50561		50279		50280	50281	50652					2.7 <sup>①</sup>	Ø8.4 <sup>④</sup>	1.3 <sup>⑤</sup>
GCSOHS-2010-M5-L		50654	50562	50563	50314	50315	50316	50317	50318	50319		50320	50321	50564	50565				2.7 <sup>②</sup>	Ø9.0	1.4 <sup>⑥</sup>
GCSOHS-2010-M6-L				50356	50357	50358	50359	50433		50360	50361	50362	50363		50364		50365	50427	3.3 <sup>③</sup>	Ø11.0	1.8 <sup>⑦</sup>

<a href="https://americom.de">https://americom.de</a>							DATE	2021-10-29	DIMENSION	TOLERANCE
TITLE	RAISED SLOTTED COUNTERSUNK SCREW						SCALE	FIT	L ≤ 4	±0.10
ARTICLE NO.	GCSOHS-2010	MOLD NO.	/	DRAW	JF	UNIT	MM	4 < L ≤ 15	±0.20	
PART NO.	SEE TABLE	MATERIAL	SEE NOTES	DESIGN	JF	VERSION	A2	15 < L ≤ 50	±0.30	
DWG NO.	E5024	COLOR	SEE NOTES	APPROVAL	FDL	VIEW		50 < L ≤ 100	±0.40	